

RESMED

ENGLISH

ResLink™

User's Manual

English

Reorder number: 308158/4 09 03

A

RESLINK

Front view

Vue avant / Frontansicht / Vista frontale / Vista frontal / Vista frontal / Vooraanzicht

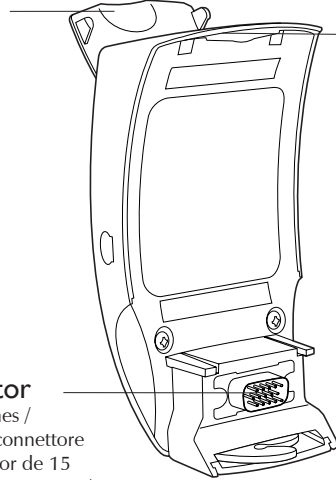
cover (open)couvercle (ouvert) /
Deckel (geöffnet) /
coperchio (aperto) /
cubierta (abierta) /
tampa (aberta) /
kap (open)**top catch**patte d'attache supérieure /
Oberer Haltezapfen / fermaglio
superiore / traba superior /
lingueta superior / bovenrand**15-pin connector**connecteur 15 broches /
Anschluss (15 Pin) / connettore
a 15 piedini / conector de 15
clavijas / conector de 15 pinos /
15-pins connector**Back view**

Vue arrière / Rückansicht / Vista posteriore / Vista posterior / Vista traseira / Achteraanzicht

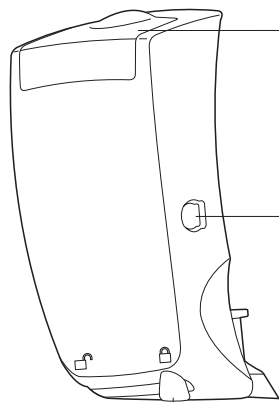
**cover (closed)**couvercle (fermé) / Deckel (geschlossen) /
coperchio (chiuso) / cubierta (cerrada) / tampa
(fechada) / kap (gesloten)**oximeter port**port de connexion de l'oxymètre /
Oximeteranschluss / porta dell'ossimetro /
puerto del oxímetro / porta do oxímetro /
oximeterpoort**locking lever**verrouillage / Verriegelungshebel / leva di
blocaggio / palanca de traba / alavanca de fecho /
vergrendelingshendel

©2009 ResMed Ltd.

B

S8 RESLINK

Front view

Vue avant / Frontansicht / Vista frontale / Vista frontal / Vista frontal / Vooraanzicht

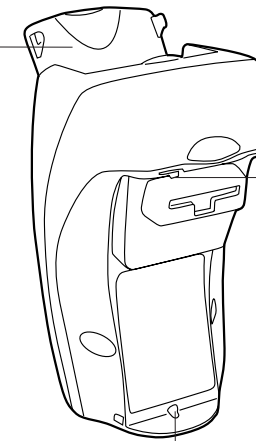
cover (open)couvercle (ouvert) /
Deckel (geöffnet) /
coperchio (aperto) /
cubierta (abierta) /
tampa (aberta) /
kap (open)**top latch**attache supérieure / Oberer
Lasche / gancio superiore /
cerrojo superior / trinco superior /
bovenste vergrendeling**bottom latch**attache inférieure / Untere Lasche / gancio
inferiore / cerrojo inferior / trinco inferior /
onderste vergrendeling**Back view**

Vue arrière / Rückansicht / Vista posteriore / Vista posterior / Vista traseira / Achteraanzicht

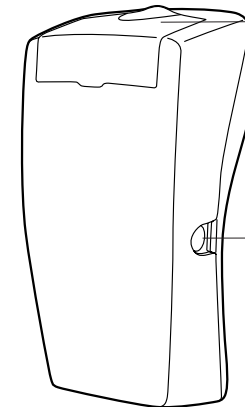
**cover (closed)**couvercle (fermé) / Deckel (geschlossen) /
coperchio (chiuso) / cubierta (cerrada) / tampa
(fechada) / kap (gesloten)**oximeter port**port de connexion de l'oxymètre /
Oximeteranschluss / porta dell'ossimetro /
puerto del oxímetro / porta do oxímetro /
oximeterpoort

©2009 ResMed Ltd.

C

SmartMedia card
 carte SmartMedia / SmartMedia-
 Karte / scheda SmartMedia /tarjeta
 SmartMedia / cartão SmartMedia /
 SmartMedia card

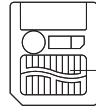

gold contacts
 contacts en or / Goldkontakte / contatti
 in oro / contactos dorados / contactos de
 ouro / goudkleurige contactpunten

©2009 ResMed Ltd.

D

sensor cable (model 8000) Adult Flex Sensor)

câble du capteur (modèle 8000) Adult Flex Sensor / Sensorkabel
 (Flexsensor Modell 8000) für Erwachsene) / cavo sensore
 (sensore flessibile per adulti modello 8000)) / cable sensor (Sensor
 Adult Flex Modelo 8000)) / Cabo sensor (Sensor Adulto Flexível
 Modelo 8000)) / sensorkabel (model 8000) Adult Flex Sensor)

oximeter sensor
 capteur de l'oxymètre / Fingersensor
 / sensore dell'ossimetro / sensor del
 oxímetro / Sensor do oxímetro / sensor
 oximeter

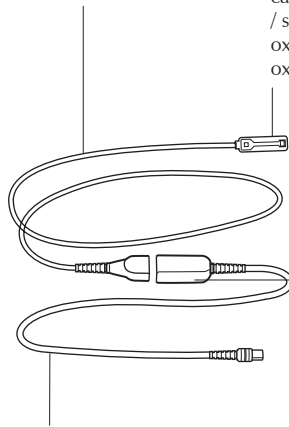

Xpod connector
 connecteur Xpod / Xpod-
 Oximeter / Connettore Xpod
 / Conector Xpod / Conector
 Xpod / Xpod-connector/vit

oximeter cable (model 3012 Pulse Oximeter)

câble de l'oxymètre (oxymètre de pouls modèle 3012) /
 Oximeterkabel (Pulseoximeter Modell 3012) / cavo dell'ossimetro
 (ossimetro da polso modello 3012) / cable del oxímetro (Oxímetro
 de pulso Modelo 3012) / cabo do oxímetro (Oxímetro de Pulso
 Modelo 3012) / oximeterkabel (model 3012 pols-oximeter)

©2009 ResMed Ltd.

E

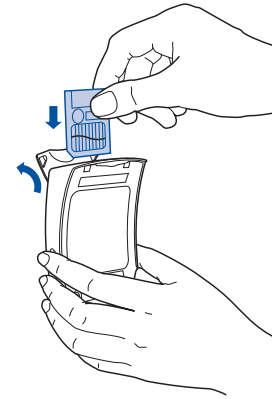

E-1



E-2

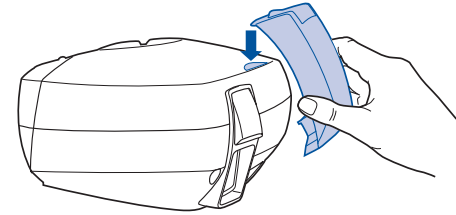

E-3

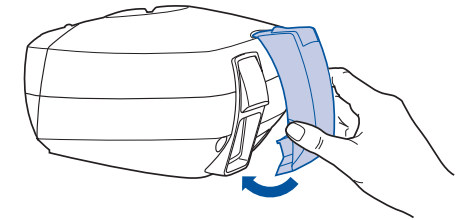

E-4

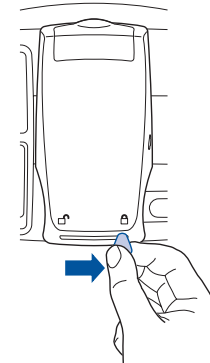

E-5

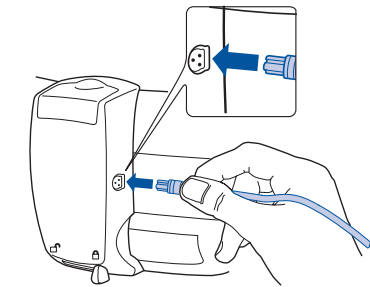

E-6

©2009 ResMed Ltd.

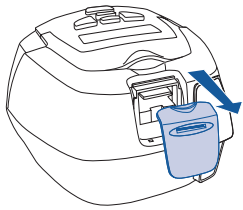
F

F-1

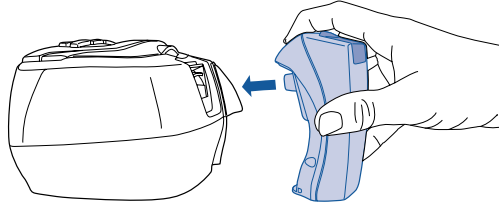

F-2

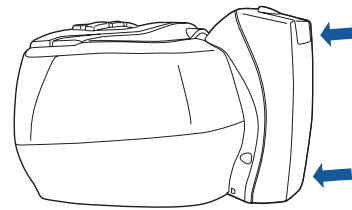

F-3

©2009 ResMed Ltd.

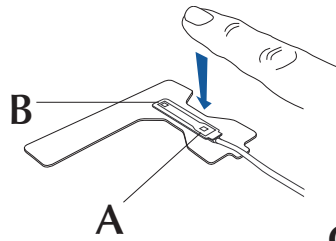
G

G-1

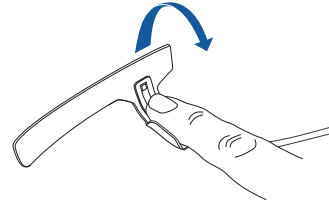

G-2

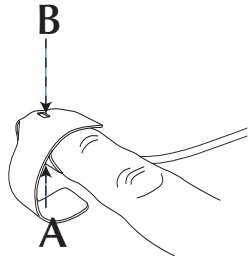

G-3

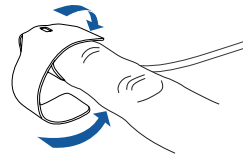

G-4

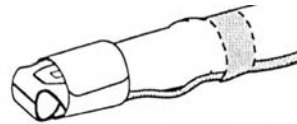

G-5

©2009 ResMed Ltd.

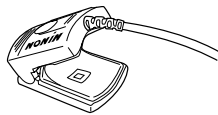
H

H-1

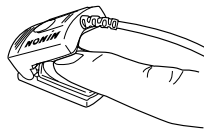

H-2

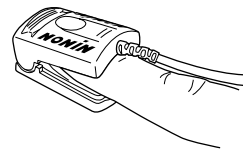

H-3

©2009 ResMed Ltd.

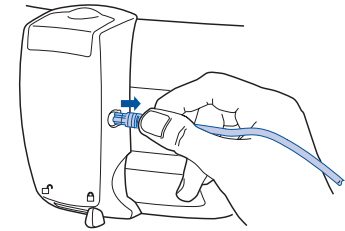
I

I-1

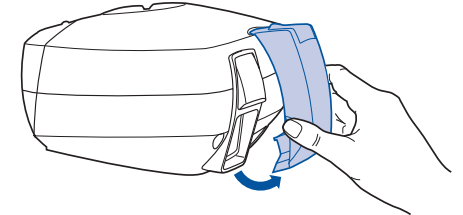

I-2

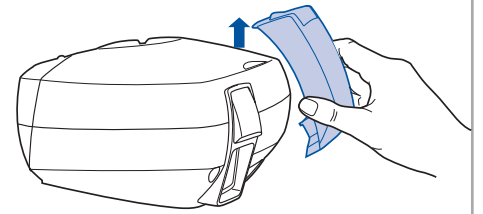

I-3

©2009 ResMed Ltd.

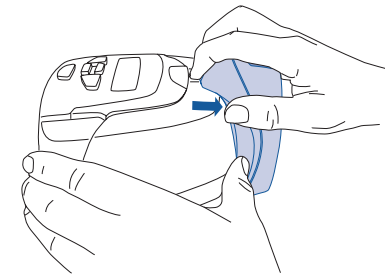
J

J-1

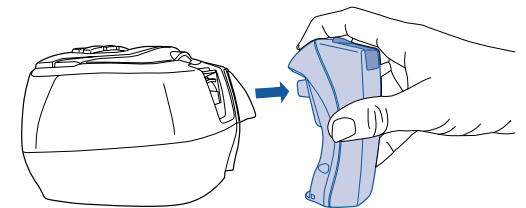

J-2

©2009 ResMed Ltd.

CONTENTS

INTRODUCTION	3
RESLINK AND S8™ RESLINK	3
USER/OWNER RESPONSIBILITY	3
INTENDED USE	3
THE RESLINK SYSTEM	5
ACCESSORIES	5
SETTING UP THE RESLINK	5
INSERTING THE CARD	5
ATTACHING THE RESLINK	5
CONNECTING AN OXIMETER TO THE RESLINK (OPTIONAL)	6
ATTACHING AN OXIMETER TO YOUR FINGER	6
USING THE RESLINK	7
STARTING TREATMENT	8
STOPPING TREATMENT	8
LCD MESSAGES	8
TYPICAL SCENARIOS	9
DISCONNECTING THE RESLINK	11
RETURNING THE RESLINK TO YOUR CLINICIAN	11
RETURNING THE SMARTMEDIA CARD TO YOUR CLINICIAN	11
CLEANING AND MAINTENANCE	12
CLEANING THE RESLINK	12
CLEANING THE OXIMETER	12
CLEANING THE OXIMETER SENSOR	12
TROUBLESHOOTING	13
TECHNICAL SPECIFICATIONS	17

INTRODUCTION

The **RESLINK™** is a device designed for use with ResMed flow generators to help your clinician monitor your sleep and ensure that you are receiving optimal treatment. When connected to the flow generator, the **RESLINK** records treatment and pulse oximetry data during therapy.

The data is stored on a SmartMedia™ card—a memory card capable of storing up to 30 sessions of detailed data. After treatment, the SmartMedia card containing the data can be removed from the **RESLINK** device and sent to your clinician for review.

RESLINK AND S8™ RESLINK

The **RESLINK** device is available in two different mechanical forms (**RESLINK** and **S8 RESLINK**) to fit different families of flow generators.

The **RESLINK** and the **S8 RESLINK** function in the same way, but they attach to and detach from the flow generator in different ways. When the word '**RESLINK**' is used in a general sense, it applies to both **RESLINK** and **S8 RESLINK**. See "Compatible flow generators" on page 18 to see which device is used with each flow generator.

Note: *The S8 ResLink may not be available in all regions.*

USER/OWNER RESPONSIBILITY

The user or owner of this system shall have sole responsibility and liability for any injury to persons or damage to property resulting from:

- operation which is not in accordance with the operating instructions supplied
- maintenance or modifications carried out unless in accordance with authorised instructions and by authorised persons.

INTENDED USE

The **RESLINK** is an accessory to ResMed flow generators that are used for the treatment of Obstructive Sleep Apnoea (OSA) in adult patients. **RESLINK** is for home and hospital use.



WARNINGS AND CAUTIONS

A Warning alerts you to possible injury.

A Caution explains special measures for the safe and effective use of the device.

The following are general warnings and cautions. Specific warnings and cautions appear next to the relevant instructions in the manual.

- Use the **RESLINK** only for its intended use as described in this manual.
- The **RESLINK** is compatible for use with certain ResMed flow generators only. See "Compatible flow generators" on page 18 for details. Do not use the **RESLINK** with any other flow generators.
- Make sure that the flow generator is turned off before connecting or disconnecting the **RESLINK**.

- Do not attempt to dismantle the **RESLINK**. There are no user serviceable parts inside. Repairs and internal servicing should only be performed by an authorised agent.
- There is a serial (9-pin) port at the back of some flow generators. Do not connect the NONIN[®] Xpod connector into the serial port as it may damage the oximeter.
- SmartMedia cards should be obtained only from ResMed as custom upgrade software may be required for operation of the **RESLINK**.
- Avoid touching the gold contacts on the SmartMedia card.
- The SmartMedia card should be kept in its plastic sleeve when not in use. This is because dirt may interfere with the **RESLINK** operation.
- Do not use the **RESLINK** in the presence of flammable or explosive materials.
- From time to time, electronic devices can be affected by irregularities in the electrical power supply. It is important to periodically check that the **RESLINK** is working correctly by checking the flow generator Liquid Crystal Display (LCD) for any error messages. This includes checking the pulse oximeter probe for correct operation by inspecting that the Light Emitting Diode (LED) on the finger probe is illuminated when the flow generator is turned on.

Contact your equipment supplier if you have any concerns about correct operation of the **RESLINK**.

THE RESLINK SYSTEM

The **RESLINK** system (**RESLINK** and SmartMedia card) is illustrated in sections A, B and C on the illustration sheet.

ACCESSORIES

See section D on the illustration sheet (8000J Adult Flex Sensor only illustrated).

The **NONIN**® Model 3012 Pulse Oximeter is compatible for use with the **RESLINK**. It can be used with either the 8000J Adult Flex Sensor or 8000AA Adult Finger Clip. The same oximeter cable can be used for either sensor. These accessories are available from ResMed.

SETTING UP THE RESLINK

See sections E and F on the illustration sheet.

Note: Your clinician may have already set up the ResLink for you.

INSERTING THE CARD



CAUTION

Avoid touching the gold contacts on the SmartMedia card.

1. Open the **RESLINK** cover.
2. Insert the SmartMedia card into the card slot on the **RESLINK** (E-1). Make sure that the card is aligned as shown in the diagram.
3. Close the cover after inserting the SmartMedia card.

ATTACHING THE RESLINK

Note: The ResLink and S8 ResLink use different attachment mechanisms.



WARNING

Before connecting the ResLink or S8 ResLink, make sure that the flow generator is powered off.

RESLINK

1. Ensure that the flow generator is powered off before attaching the **RESLINK**. Use the switch at the back of the flow generator to power off the device.
2. Slide the lever at the back of the **RESLINK** to the left (E-2).
3. Place the top catch of the **RESLINK** onto the notch at the back of the flow generator (E-3).
4. Push the bottom of the **RESLINK** onto the auxiliary port at the back of the flow generator (E-4).
5. Slide the lever at the back of the **RESLINK** to the right, to lock the **RESLINK** in place (E-5).

S8 RESLINK

1. Ensure that the flow generator is powered off before attaching the **S8 RESLINK**. You will need to turn the power off at the wall outlet.
2. Take off the module currently attached to the flow generator (F-1) and store it in the flow generator bag.
3. Push the **S8 RESLINK** onto the flow generator (F-2), making sure that both the top and bottom latches engage firmly with the flow generator.

Note: The S8 ResLink does not have a locking lever.

4. When attached, the **S8 RESLINK** should fit closely onto the back of the flow generator (F-3).

CONNECTING AN OXIMETER TO THE RESLINK (OPTIONAL)

Your clinician may have supplied an oximeter for use with the **RESLINK**. Connecting an oximeter to the **RESLINK** allows collection and storage of oximetry data (oxygen saturation and pulse rate).

1. Ensure that the sensor cable is properly connected to the Xpod connector (see illustration D).
2. Insert the oximeter plug into the **RESLINK** oximeter port (E-6).



WARNING

- Only the **NONIN Model 3012 Pulse Oximeter** and **Models 8000J or 8000AA Sensors** are compatible with the ResLink. Connecting other oximeters may cause personal injury or damage to the flow generator or the ResLink.
- Check the oximeter cables and the oximeter sensor before use. If there is any sign of damage or wear contact your equipment supplier.
- There is a serial (9-pin) port at the back of some flow generators. Do not connect the **NONIN Xpod** connector into the serial port as it may damage the oximeter.

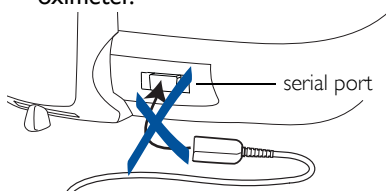

ATTACHING AN OXIMETER TO YOUR FINGER



CAUTION

The oximeter sensor will not function properly if there is nail polish on your fingernails.

Note: Do not attach the oximeter until you are ready to start therapy.

ATTACHING THE NONIN 8000J ADULT FLEX SENSOR

See section G on the illustration sheet.

Your clinician will have attached the sensor to the adhesive side of the FlexiWrap.

1. Remove the adhesive backing from the FlexiWrap.
2. Carefully position any one of your fingers (not the thumb) on diode A on the FlexiWrap (G-1). Wrap the two small lower flaps onto the sides of your finger.
3. Carefully fold the FlexiWrap over the tip of your finger (G-2). Diode B must be positioned on your fingernail. Check that the two diodes are aligned, with B directly above A (G-3).
4. Wrap the long flap around your finger to secure the sensor (G-4). The FlexiWrap should feel firm, but not uncomfortably tight.
5. Secure the sensor wire to the base of the finger or wrist using medical tape (G-5).

ATTACHING THE NONIN 8000AA ADULT FINGER CLIP

See section H on the illustration sheet.

1. Open the Finger Clip (H-1) and place your finger inside the device (H-2).
2. Close the Finger Clip (H-3).
3. Secure the sensor wire to the base of the finger or wrist using medical tape.

Note: For more details, please refer to the user guide supplied with the oximeter.

USING THE RESLINK

1. Turn on the flow generator. A series of messages will be displayed on the flow generator LCD. When the following message is displayed, you know that the RESLINK is correctly connected.

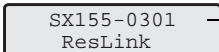

SX155-0301
ResLink

The number displayed will reflect the ResLink software version

2. If necessary, the software in your flow generator will be automatically upgraded. The upgrade ensures that your flow generator is compatible for use with the RESLINK.



WARNING

The flow generator will not deliver therapy during the upgrade. Do not put the mask on until the upgrade is completed.

During upgrade, the LCD backlight flashes and the following is displayed:

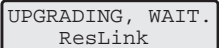

UPGRADING, WAIT.
ResLink

On some flow generators, this screen may be shown in multiple languages prior to upgrade.

The upgrade can take up to 20 minutes. Please wait for completion. When upgrade is successful the WELCOME screen will be displayed on the LCD.

Note: If the upgrade is interrupted for any reason, turn the flow generator off, ensure the ResLink is properly attached and the SmartMedia card is inserted, then turn the flow generator back on to restart the upgrade. Note that the LCD message may not be shown following an interruption; the screen may be blank for up to 20 minutes during the upgrade.

STARTING TREATMENT

Start treatment as described in the flow generator User's Manual. The **RESLINK** will automatically collect and store treatment data.

STOPPING TREATMENT

Press the Front key on your flow generator to stop therapy at the end of the night. If attached, remove the oximeter sensor from your finger.

After stopping therapy on the last night that you use the **RESLINK**, wait for 15 minutes then turn off your flow generator at the power switch.



CAUTION

Do not power the flow generator on or off while the ResLink is being used, as this may stop the gathering of data. If there is any interruption to the flow generator's power supply, wait 15 minutes to commence therapy after powering the flow generator back on.

LCD MESSAGES

You may see the following **RESLINK** messages briefly displayed on the flow generator LCD to inform you about the operation of the **RESLINK**. These messages will be interspersed with other flow generator messages.

SX155-0301
ResLink

Successful ResLink connection
(number displayed will be current
ResLink software version)

FOUND CARD
ResLink 1 / 4

SmartMedia Card has been
detected

INSERT CARD!
ResLink 1 / 4

SmartMedia Card has not been
detected

FOUND OXIMETER
ResLink 2 / 4

Oximeter is present

NO OXIMETER
ResLink 2 / 4

Oximeter is not present

COPYING, WAIT...
ResLink 3 / 4

Summary data is being copied to
the SmartMedia Card

READY.
ResLink 4 / 4

ResLink ready to record Detailed
Data

NO CARD
ResLink

SmartMedia Card has been
removed

NO OXIMETER
ResLink

Oximeter has been disconnected

UPGRADING, WAIT.
ResLink

The flow generator is being
upgraded by the ResLink

When an oximeter is attached, a set of six messages similar to those shown below is displayed in sequence. These messages indicate the current oxygen saturation (SpO₂) and heart rate being measured by the oximeter. They are intended to assist you in making sure that the oximeter is correctly attached. The sequence runs for approximately one minute.

```
SpO2: 98% HR: 65
OXIMETER 1 / 6
```

Message 1: displays oxygen saturation (SpO₂) and heart rate (HR)



Messages 2, 3, 4 and 5: sequence showing information similar to Message 1



```
SpO2: 99% HR: 59
OXIMETER 6 / 6
```

Message 6

Note: If you see a message similar to that shown below, with dashes instead of numeric values, check to make sure that the oximeter sensor is correctly attached to your finger.

```
SpO2: ---% HR: ---
OXIMETER 1 / 6
```

TYPICAL SCENARIOS

SCENARIO 1: NO OXIMETER ATTACHED

This scenario shows the typical sequence of messages displayed when the **RESLINK** has been correctly set up, the flow generator is powered on and no oximeter is attached. These messages will be interspersed with other flow generator messages.

```
SX155-0301
ResLink
```

Successful ResLink connection



```
FOUND CARD
ResLink 1 / 4
```

Indicates that the SmartMedia Card is present



```
NO OXIMETER
ResLink 2 / 4
```

Indicates that the oximeter is not attached



```
COPYING, WAIT...
ResLink 3 / 4
```

This screen is displayed on the LCD for 2-5 minutes depending on the amount of Summary Data being transferred.



```
READY.
ResLink 4 / 4
```

Indicates that the ResLink has finished copying the Summary Data and is now ready to log Detailed Data.

This screen clears after a few seconds.

SCENARIO 2: OXIMETER ATTACHED

This scenario shows the typical sequence of messages displayed when the **RESLINK** has been correctly set up, the flow generator is powered on and an oximeter is attached. These messages will be interspersed with other flow generator messages.

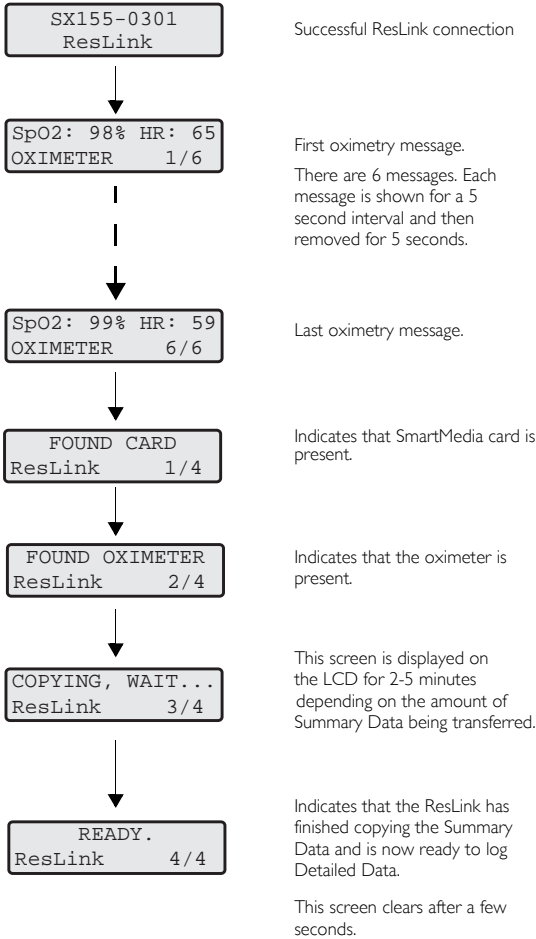

DISCONNECTING THE RESLINK

See sections I and J on the illustration sheet.



WARNING

Before disconnecting the ResLink, make sure that the flow generator is powered off.

If an oximeter is connected, pull the oximeter plug out of the RESLINK oximeter port (I-1).

RESLINK

1. Turn the flow generator power off using the power switch.
2. Slide the lever at the back of the RESLINK to the left (E-2). This unlocks the RESLINK from the flow generator.
3. Carefully pull the RESLINK away from the flow generator (I-2, I-3).
4. Store the RESLINK in its pouch.

S8 RESLINK

1. Turn the power off at the wall outlet.
2. To remove the S8 RESLINK from the flow generator, grip it from the top (J-1).
3. Pull the S8 RESLINK away from the flow generator (J-2).
4. Take the module that you took off the flow generator (F-1) and put it back on in its original place.
5. Store the S8 RESLINK in its pouch.

RETURNING THE RESLINK TO YOUR CLINICIAN

If you are returning the RESLINK to your clinician, leave the SmartMedia card in place. Put the RESLINK in its pouch and contact your clinician or equipment supplier for details regarding return.

RETURNING THE SMARTMEDIA CARD TO YOUR CLINICIAN

If you are returning only the SmartMedia card to your clinician:

1. Open the RESLINK cover and remove the SmartMedia card. Close the cover after removing the SmartMedia card.
2. Place the SmartMedia card in its plastic sleeve.
3. Place the SmartMedia card in the mailback card supplied with the RESLINK.



CAUTION

If returning the SmartMedia card through the postal service, always use a padded envelope.

CLEANING AND MAINTENANCE



CAUTION

Avoid exposing the ResLink to moisture and extreme temperatures.

CLEANING THE RESLINK

If necessary, wipe the outside of the RESLINK with a clean cloth.

CLEANING THE OXIMETER

1. If necessary, wipe the surfaces with a soft cloth dampened with isopropyl alcohol or a mild detergent.
2. Dry with a soft cloth or allow to air dry.

Note: *The oximeter cable and Xpod connector can be wiped with a clean cloth.*



CAUTION

Do not autoclave or immerse this device in liquid or use caustic or abrasive cleaning agents or any cleaning products containing ammonium chloride.

CLEANING THE OXIMETER SENSOR

For instructions on cleaning the oximeter sensor, please refer to the user guide supplied with this device.



WARNING

- Do not use liquids to clean any part of the ResLink.
- Do not attempt to dismantle the ResLink. Under no circumstances should you attempt to service or repair the device yourself. There are no user serviceable parts inside. Inspection and repair should only be performed by an authorised agent.

TROUBLESHOOTING

If there is a problem, try the following suggestions. If the problem cannot be solved, contact your equipment supplier. Do not attempt to open the **RESLINK**.

Problem	Possible Cause	Solution
Difficulty attaching the RESLINK to the flow generator.	Incompatible flow generator.	The RESLINK and S8 RESLINK are compatible for use with certain ResMed flow generators only. See "Compatible flow generators" on page 18.
	The RESLINK may be attached incorrectly.	See "Attaching the ResLink" on page 5.
Flow generator and RESLINK not working (no display on LCD).	Power cord is not plugged into the flow generator or power outlet properly.	Check that the power cord is plugged firmly at the back of the flow generator and into a working power outlet.
	Flow generator not powered on.	Check that the flow generator is turned on.
	Faulty power outlet.	Try another power outlet.
Flow generator LCD continuously displays black boxes or blank screen on power up.	Previous failed software upgrade.	Power off the flow generator. Attach RESLINK with a SmartMedia card inserted. Power on the flow generator. Allow 20 minutes for the software upgrade. Note: During the upgrade the 'UPGRADING, WAIT' screen may not be displayed.
The following messages are displayed on the LCD of an AutoSet CS2 flow generator that has had a RESLINK connected:	Upgrade failed due to loss of power to the AutoSet CS2.	Power off the flow generator. Attach RESLINK with a SmartMedia card inserted. Power on the flow generator. Allow 20 minutes for the software upgrade. Note: During the upgrade the 'UPGRADING, WAIT' screen may not be displayed.
<div style="border: 1px solid black; padding: 5px; width: fit-content; margin-bottom: 10px;">No signature and bad CRC</div> <div style="border: 1px solid black; padding: 5px; width: fit-content;">Waiting for File upload</div>		

Problem	Possible Cause	Solution
The ‘Successful Reslink connection’ message (see page 8) is not displayed after power up.	The RESLINK is not securely attached to the flow generator.	Power the flow generator off. Ensure that the RESLINK is securely connected to the flow generator. Also ensure that the lever at the back of the RESLINK is in the lock position. Power the flow generator back on. For the S8 RESLINK make sure that the top and bottom latches are secured properly.
	Incompatible flow generator.	The RESLINK and S8 RESLINK are compatible for use with certain ResMed flow generators only. See “Compatible flow generators” on page 18.
	Faulty RESLINK.	Contact your equipment supplier.
Difficulty inserting the SmartMedia card into the RESLINK.	Incompatible memory card used.	Ensure that a SmartMedia card, obtained from ResMed only, is used.
	The SmartMedia card is inserted incorrectly.	See “Inserting the Card” on page 5.
A SmartMedia card is inserted but	Software upgrade not required.	This is OK. Continue with setup.
<div style="border: 1px solid black; padding: 2px; width: fit-content; margin: 5px auto;">UPGRADING, WAIT. ResLink</div> <p>is not displayed.</p>		
The following is displayed on the LCD when a SmartMedia card is inserted and the flow generator is powered on:	SmartMedia card cannot be accessed—it may be partially inserted. Alternatively, the gold contacts could be dirty.	Power the flow generator off. Remove and then re-insert the SmartMedia card.
	<div style="border: 1px solid black; padding: 2px; width: fit-content; margin: 5px auto;">CARD ERROR! ResLink 1/4</div>	The SmartMedia Card may be damaged.
During software upgrade, a blank screen is displayed on the LCD.	Loss of power supply to the flow generator.	Power the flow generator off. Re-insert the SmartMedia card. Check the power supply to the flow generator. Power the flow generator back on. See “Using the ResLink” on page 7.

Problem	Possible Cause	Solution
<p>A SmartMedia card containing upgrade software is inserted and the following is displayed on the LCD:</p> <div style="border: 1px solid black; padding: 5px; width: fit-content; margin: 10px auto;"> UPGRADE FAILED ResLink </div>	<p>Incompatible flow generator, or alternatively the flow generator cannot be upgraded.</p> <p>Flow generator was delivering therapy.</p>	<p>Power the flow generator off. Remove the RESLINK with SmartMedia card inserted. Contact your equipment supplier.</p> <p>Stop therapy. Power the flow generator off. Check the power supply to the flow generator. Power the flow generator back on. See "Using the ResLink" on page 7.</p>
<p>Difficulty inserting the oximeter into the RESLINK.</p>	<p>Incompatible oximeter used.</p> <p>Oximeter plug not oriented correctly.</p>	<p>Ensure that a NONIN (Model 3012) Pulse Oximeter is used. See "Connecting an Oximeter To the ResLink (optional)" on page 6.</p> <p>See "Connecting an Oximeter To the ResLink (optional)" on page 6.</p>
<p>The following message is displayed on the LCD:</p> <div style="border: 1px solid black; padding: 5px; width: fit-content; margin: 10px auto;"> OXIMETER FAULT ResLink </div>	<p>Incompatible oximeter.</p> <p>The oximeter sensor cable and Xpod connector are not properly connected.</p> <p>Faulty oximeter.</p>	<p>Ensure that a NONIN (Model 3012) Pulse Oximeter is used.</p> <p>Ensure that the oximeter sensor cable and Xpod connector are properly connected.</p> <p>Contact your equipment supplier.</p>
<p>The following message is displayed on the LCD:</p> <div style="border: 1px solid black; padding: 5px; width: fit-content; margin: 10px auto;"> INSERT CARD! ResLink 1 / 4 </div>	<p>The SmartMedia card has not been inserted or correctly positioned in the RESLINK.</p>	<p>Power off the flow generator, re-insert the SmartMedia card and power the flow generator back on.</p>
<p>The following message is displayed on the LCD for more than 20 minutes and never leaves this state.</p> <div style="border: 1px solid black; padding: 5px; width: fit-content; margin: 10px auto;"> UPGRADING, WAIT. ResLink </div>	<p>Software upgrade not yet completed.</p> <p>The SmartMedia card has been removed during software upgrade.</p> <p>Faulty SmartMedia card.</p> <p>Damaged flow generator.</p>	<p>Wait another 10 minutes.</p> <p>Power the flow generator off. Re-insert the SmartMedia card. Power the flow generator back on. See "Using the ResLink" on page 7</p> <p>Power the flow generator off. Contact your equipment supplier.</p> <p>Power the flow generator off. Contact your equipment supplier.</p>

TECHNICAL SPECIFICATIONS

RESLINK

Dimensions (H x W X D):

126mm x 65mm x 60mm

Weight: 110 g

Power Supply:

Maximum power consumption derived from the flow generator: 200mA at 24-30V

S8 RESLINK

Dimensions (H x W X D):

120 mm x 65 mm x 65 mm

Weight: 114 g

Power Supply:

Maximum power consumption derived from the flow generator: 400mA at 12V

RESLINK AND S8 RESLINK

Housing Construction:

Flame retardant engineering thermoplastic.

IEC 60601-1 Classification: Class II (double insulation), Type CF

Electromagnetic Compatibility

Product complies with all applicable electromagnetic compatibility requirements (EMC) according to IEC60601-1-2, for residential, commercial and light industry environments.

Environmental Conditions

Operating Temperature: 5°C to 40°C

Operating Humidity: 10%–95% non-condensing

Storage and Transport Temperature: -20°C to 60°C

Storage and Transport Humidity: 10%–95% non-condensing

NONIN MODEL 3012 PULSE OXIMETER, 8000J ADULT FLEX SENSOR AND 8000AA ADULT FINGER CLIP

SpO₂

70–100% ± 3 digits

Pulse rate

18 to 300 pulses per minute ± 3% ± 1 digit

Environmental Conditions

Operating Temperature: 0°C to 50°C

Operating Humidity: 10%–90% non-condensing

Storage and Transport Temperature: -20°C to 50°C

Storage and Transport Humidity: 10%–95% non-condensing

COMPATIBLE FLOW GENERATORS¹

Compatible with ResLink	Compatible with S8 ResLink
AutoSet Spirit™	S8 AutoSet Spirit™
VPAP™ III series	S8 Elite™
S7™ Elite	S8 AutoScore™
AutoSet CS™2	S8 AutoSet Vantage™
VPAP™ Adapt SV	S8 AutoSet Spirit™ II
VPAP™ Malibu	S8 Elite™ II
	S8 AutoScore™ II
	VPAP™ Auto
	S8 AutoSet™ II

GLOSSARY OF SYMBOLS



Attention, consult accompanying documents



Type CF applied part



Class II equipment



IPX1

Drip proof



Environmental information

WEEE 2002/96/EC is a European Directive that requires the proper disposal of electrical and electronic equipment. This device should be disposed of separately, not as unsorted municipal waste. To dispose of your device, you should use appropriate collection, reuse and recycling systems available in your region. The use of these collection, reuse and recycling systems is designed to reduce pressure on natural resources and prevent hazardous substances from damaging the environment.

If you need information on these disposal systems, please contact your local waste administration. The crossed-bin symbol invites you to use these disposal systems. If you require information on collection and disposal of your ResMed device please contact your ResMed office, local distributor or go to www.resmed.com/environment.

¹ Not all flow generators are available in all regions